



Manufacturer of shut-off and control valves

TECHNICAL DATA SHEET

Two-way solenoid solenoid valve ELEPHANT-DW31 DN10-DN25 (3/8" - 1") direct acting normally closed type, with coil 220V/24V



+34 900 433 073, sales@valveelephant.com
Carrer d'Aragó, 264, 3-1, 08007 Barcelona, Spain

GENERAL PRODUCT INFORMATION

Product name: Two-way solenoid valve ELEPHANT-DW31 DN10-DN25 (3/8" - 1") of direct action normally closed type, with coil 220V/24V.

Purpose: Solenoid valve is a special device designed for convenient control of the working medium. This process is carried out in a pressurized pipeline.

In a normally closed solenoid valve, the closed position is maintained if no control voltage is applied to its induction coil. When voltage is applied to the coil, the normally closed valve opens and allows the process medium to flow through. When the control voltage is switched off, the valve closes automatically and blocks the medium flow in the pipeline.



BASIC TECHNICAL DATA AND CHARACTERISTICS

Nominal diameter DN, mm (inch)	10 – 25 (3/8"-1")
Working pressure PN, bar	0...10
Media temperature t, °C	-10 to +80: NBR -10 to +150: VITON -10 to +120: EPDM
Working medium	Water, liquid media, air, gaseous media, light oils (viscosity ≤ 20 cSt)
Operating principle	direct
Device type	Normally closed
Connection to pipeline	Threaded Threaded
Thread type	G
Coil supply	AC220V or DC24V
Housing material	Brass/steel 304/steel 316
Sealing	NBR/VITON/EPDM
Protection class	IP65
Coil insulation class	F
Coil type	-Normal -Low power (*option)
Coil construction	With lead wires/ DIN connectors
Suitable coil models	-S91B (22VA(AC), 17W(DC), IP65, encapsulation complete) -S51B (30VA(AC), 24W(DC), IP65, encapsulation complete) -SD01B (28VA(AC), 36W(DC), IP65, encapsulation complete)



VALVE DIMENSIONS

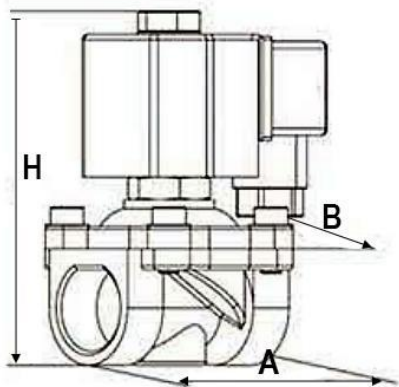

DN	Ø aisle	Ø holes	A	B	H	Weight (kg)	
	inch	mm				brass	Steel 304
10	3/8"	12	68	56	95	0.66	0.6
15	1/2"	15	68	56	95	0.66	0.6
20	3/4"	20	68	56	102	0.69	0.6
25	1"	25	95	73	115	0.90	0.8

BASIC VALVE PARAMETERS

Model	DN	Ø aisle	Ø holes	Throughput	Working pressure (MPa)			Coil power				Coil model
								Normal coil		Low power coil		
		Minimum pressure	Maximum pressure		AC	DC	AC	DC				
inch	mm		m3/hour	AC	DC	VA	W	VA	W			
DW31-10	10	3/8"	12	4.5	0	1.0	1.0	33	20	4	4	S51B
DW31-15	15	1/2"	15	4.5	0	1.0	1.0	33	20	4	4	
DW31-20	20	3/4"	20	9.3	0	1.0	1.0	33	20	4	4	
DW31-25	25	1"	25	12	0	1.0	1.0	33	20	4	4	



WARRANTY PERIOD

Warranty period - 12 months from the date of commissioning, but not more than 18 months from the date of sale.

The warranty does not apply:

- parts and materials of the product subject to wear and tear
- for cases of damage caused by:
 - violations of the product storage, installation, testing, operation and maintenance specifications;
 - improper transportation and handling operations;
 - the presence of traces of exposure to substances aggressive to the product materials;
 - presence of damage caused by fire, elements, force majeure circumstances;
 - damage caused by incorrect actions of the consumer;
 - traces of tampering with the design of the product.

SALES MARK

No	Product Name	Packs

Date of Sale: _____

L.S.

