



Manufacturer of shut-off and control valves

TECHNICAL DATA SHEET

**Thermostatic condensate drain ELEPHANT
STS3131P-T DN15-25 40 bar
stainless steel, threaded**



+34 900 433 073, sales@valveelephant.com
Carrer d'Aragó, 264, 3-1, 08007 Barcelona, Spain

1. GENERAL PRODUCT INFORMATION

1.1. Product name: Thermostatic condensate drain ELEPHANT STS3131P-T DN15-25 40 bar stainless steel, threaded.

1.2. Purpose: The condensate drain is designed to release condensate, air and other non-condensable gases from the steam system, as well as to delay steam until its complete condensation.

1.3. Principle of operation. The principle of operation is based on the temperature difference between steam and condensate. The change in temperature leads to boiling/condensation of the liquid inside the capsule connected to the outlet valve, which allows non-condensable gases and condensate to be discharged below the saturation temperature.



** the image may differ from the original*



1.5. Deciphering of the designation:

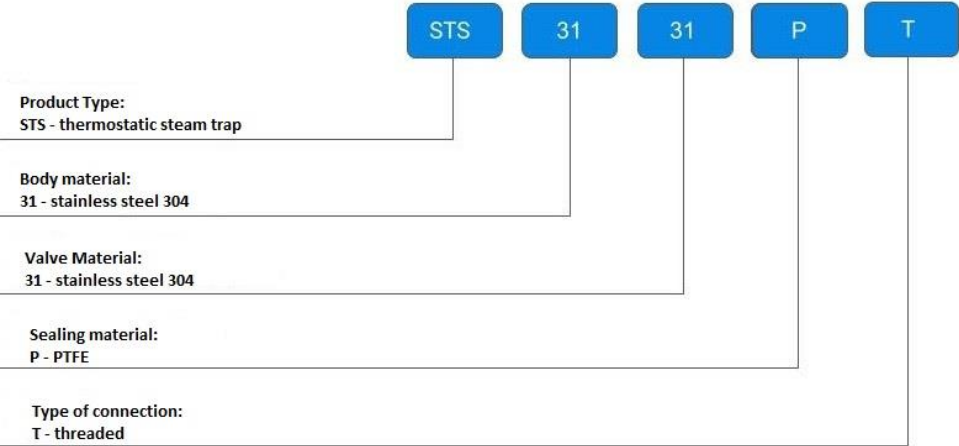

2. BASIC TECHNICAL DATA AND CHARACTERISTICS

Table 1

Nominal diameter DN, mm	15-25
Working pressure PN, bar	40
Condensate trap type	thermostatic
Operating medium	water vapor, condensate
Maximum permissible medium temperature, °C	250
Operating conditions	UHL 1
Direction of medium flow	housing arrow
Pipeline connection	threaded BSPT
Location on the pipeline	upright (top to bottom)
Minimum pressure drop across the Minimum pressure drop across the condensate drain for normal operation, bar	0,2
Limitations	the maximum pressure downstream of the condensate drain should be no more than 90% of the pressure upstream of the condensate drain
Service life, years	10



Table 2. Limitations of application.

Working medium pressure, bar	Maximum medium temperature, °C
26,1	250
27,5	200
29,0	150
30,8	100

Table 3: Throughput capacity, kg/h.

DN	Pressure drop, bar								
	1	2	4	6	8	10	12	14	21
15-25	95	135	215	250	290	320	355	400	450

* condensate flow rate is specified at a temperature 10°C below saturation temperature



3. BASIC MATERIALS

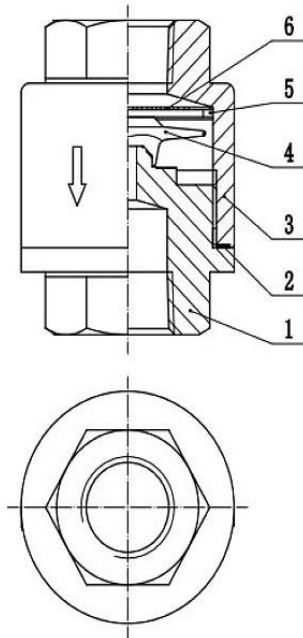

Table 4

Nº	Part name	Material
1	Case	steel AISI 304
2	Gasket	PTFE
3	Cover	steel AISI 304
4	capsule	stainless steel alloy
5	locking ring	steel AISI 304
6	Filter	steel AISI 304



4. WEIGHT AND DIMENSIONAL PARAMETERS

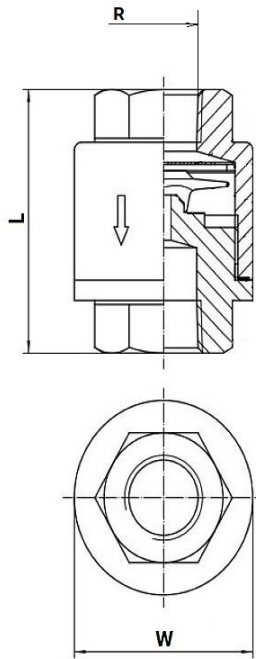

Table 5

DN	L, mm	W, mm	R	Weight, kg
15	65	48	BSPT 1/2"	0,6
20	65	48	BSPT 3/4"	0,6
25	71	53	BSPT 1"	0,8



5. OPERATING INSTRUCTIONS

5.1. ELEPHANT STS3131P-T condensate traps do not require special maintenance. The scope and intervals of maintenance are determined by the operating organization based on the operating conditions.

5.2. Suitable shut-off valves should be provided to ensure that the required section of the pipeline can be safely shut off for any work to be carried out on it.

5.3. When traps are used in new systems that have not been flushed, it may be necessary to inspect and clean the trap. Before servicing, isolate the section of pipe with the trap and depressurize to zero. Allow the trap to cool down. During assembly, make sure that all mating surfaces are clean.

5.4. Maintenance and repair can be carried out without removing the trap from the piping if the necessary precautions are observed. Prior to installation, disassembly and maintenance work, disconnect the trap from steam and condensate sources and depressurize the system.

5.5. The internal instructions of the company must be followed when operating the traps.

6. INSTALLATION INSTRUCTIONS

6.1. The installation, operation and maintenance of condensate traps may be carried out by personnel who have studied the product design, safety rules, requirements of this TP and have skills in working with condensate traps.

6.2. Before installing a condensate trap, the piping must be cleaned of contaminants by purging. All filters must also be purged if they are installed upstream of the traps.

6.3. If there is a possibility that the system may be pressurized above the pressure limit for the condensate drain, make sure that a safety valve is in place.

6.4. If draining to the atmosphere, ensure that condensate is drained to a safe place.

6.5. The condensate drain must be installed in such a way that the direction of the medium flow coincides with the direction of the arrow on the housing.



7. TRANSPORTATION AND STORAGE CONDITIONS

7.1. Transportation and storage conditions - in the packaging of the manufacturer according to the internal instructions of the company.

7.2. Condensate traps may be transported unpacked provided that they are protected from shock loads and other mechanical effects.

7.3. Condensate drainers, which are in long-term storage, are subject to periodic inspection at least once a year. In case of violation of preservation to make preservation again. Conservation lubricant should be applied on degreased clean and dry surface of parts. Degreasing should be performed with a clean rag soaked in gasoline.

8. UTILIZATION

8.1. The product is disposed of in accordance with the procedure established at the enterprise (remelting, burial, resale).

8.2. Before the valve is sent for disposal, the residues of the working medium shall be removed from the valve. Methods of removal of the working medium and decontamination of the valve must be approved in accordance with the established procedure at the enterprise operating the product.



9. WARRANTY OBLIGATIONS

9.1. Warranty period - 12 months from the date of commissioning, but not more than 18 months from the date of sale.

9.2. The warranty applies to equipment installed and used in accordance with the installation instructions and product specifications described in this data sheet.

9.3. The manufacturer guarantees compliance of the product with safety requirements, provided that the consumer complies with the rules of transport, storage, installation and operation.

9.4. The warranty covers all defects caused by the fault of the manufacturer.

9.5. The warranty does not apply:

- parts and materials of the product subject to wear and tear;
- for cases of damage caused by:
 - modifications to the original design of the product;
 - violation of general installation recommendations;
 - faults caused by improper maintenance and storage; improper operation and use of the equipment.

10. WARRANTY TERMS

10.1. Claims to the quality of the goods may be made during the warranty period.

10.2. Defective products are repaired or exchanged for new ones free of charge during the warranty period. ELEPHANT decides whether to replace or repair the product. The replaced product or its parts resulting from the repair shall become the property of 'ELEPHANT'.

10.3. Costs related to dismantling, installation and transport of the defective product during the warranty period shall not be reimbursed to the Buyer.

10.4. If the claim is unfounded, the Buyer shall pay the costs of diagnostics and expertise of the product.

10.5. Products are accepted for warranty repair (as well as for return) fully assembled.



WARRANTY CARD № _____

№	Product Name	Packs

Name and address of the trading organisation _____

Date of sale _____ Seller's signature _____

Stamp or seal of the trading organisation _____ Acceptance stamp _____

I agree with the terms and conditions of the warranty:

Buyer _____ (signature)

Warranty period - 12 months from the date of commissioning, but not more than 18 months from the date of sale.

For warranty repairs, complaints and product quality claims, please contact ELEPHANT at: Carrer d'Aragó,264,3-1,08007 Barcelona, Spain_E-mail address: sales@valveelephant.com.

When making a complaint about the quality of goods, the buyer shall present the following documents:

1. A free-form application, which shall specify:
 - name of the organisation or full name of the buyer, actual address, contact telephone numbers;
 - name and address of the organisation that carried out the installation;
 - basic parameters of the system in which the product was used;
 - a brief description of the defect.
2. Document confirming the purchase of the product (delivery note, receipt).
3. Act of hydraulic test of the system in which the product was installed.
4. This completed warranty card.

A note on the return or exchange of goods _____

Date: « ___ » _____ 202__ r. Caption _____

