



Manufacturer of shut-off and control valves

## TECHNICAL DATA SHEET

**Rubber compensator ELEPHANT CR-N34-F  
DN25-300 16 bar NBR, flanged**



+34 900 433 073, sales@valveelephant.com  
Carrer d'Aragó, 264, 3-1, 08007 Barcelona, Spain

## 1. GENERAL PRODUCT INFORMATION

1.1. Product name: Rubber compensator ELEPHANT CR-N34-F DN25-300 16 bar NBR, flanged.

1.2. Purpose: The compensator is designed to reduce vibration and noise in pipelines due to pumps or other equipment. It also compensates for temperature displacements of pipelines and facilitates installation in case of slight misalignment of the connected system elements.

1.3. Principle of operation: The rubber insert compensates for shifts due to its flexibility. It is reinforced with synthetic fibres at the edges and steel rings at the ends. This ensures that the rubber compensator is securely fastened and prevents leakage at the joints.



#### 1.4. Deciphering of the designation:

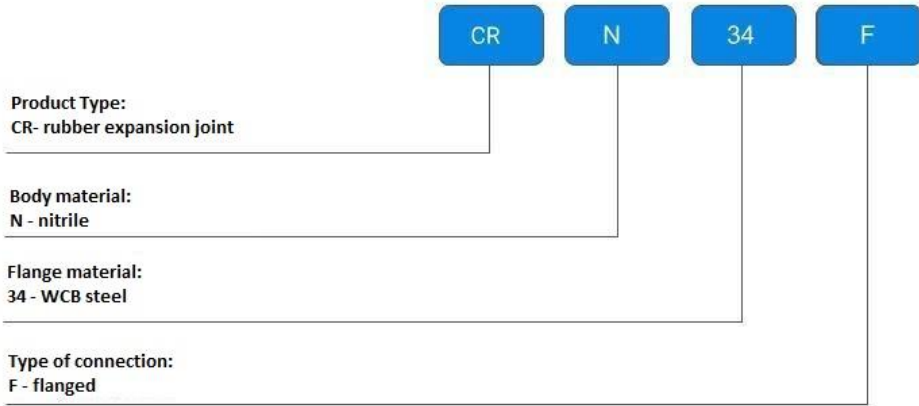

## 2. BASIC TECHNICAL DATA AND CHARACTERISTICS

Table 1

Parameter	Value
<b>Nominal Diameter DN, mm</b>	25 - 300
<b>Working Pressure PN, bar</b>	16
<b>Operating Temperature t, °C</b>	-20 to +80
<b>Working Medium</b>	Water (sea, demineralized, distilled, etc.), mineral oils, gasoline, diesel fuel, gas, methane, propane, refrigerants of groups HFA, HFB, HFC
<b>Body Material</b>	NBR (vulcanized butadiene-nitrile rubber)

\* The use of solvent as a working medium is prohibited



### 3. BASIC COMPONENT MATERIALS

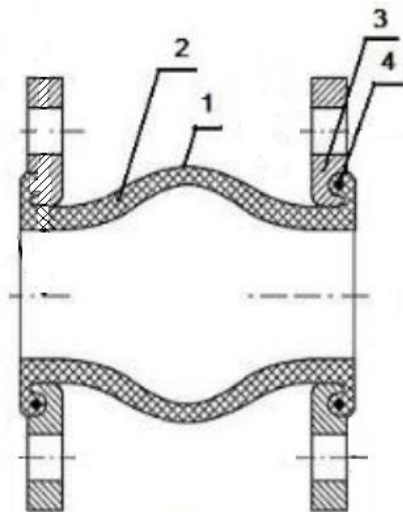

Table 2

№	Component Name	Material
1	Body	NBR
2	Body Reinforcement	Nylon tire cord
3	Flanges	Galvanized steel WCB
4	Wire Rings	Steel



#### 4. WEIGHT AND DIMENSIONAL PARAMETERS

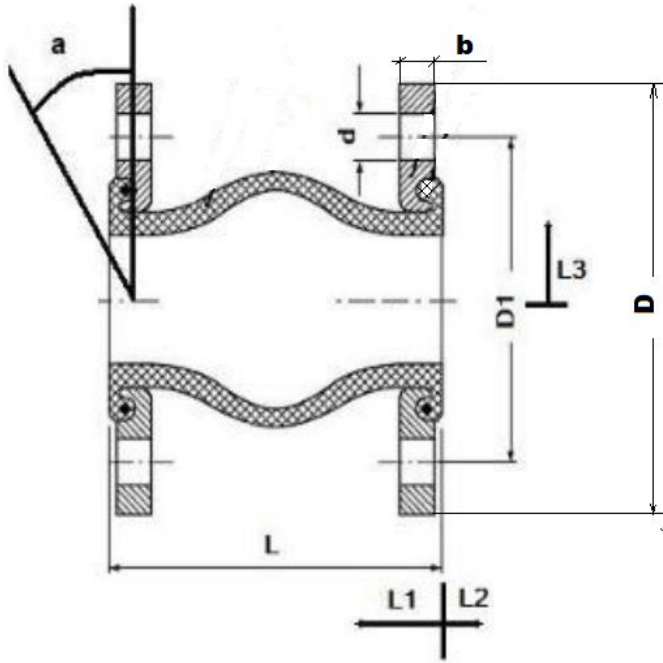

Table 3

DN	a, permissible angular misalignment	L1, permissible compression, mm	L2, permissible tensile strength, mm	L3, permissible linear displacement (shear), mm	Weight, kg
25	5°	8	2	4	2,0
32		8	2	4	3,0
40		8	2	4	4,5
50		8	3	4	5,0
65		12	3	5	6,0
80		12	5	5	7,5
100		18	5	6	9,0
125		18	5	6	12,0
150		18	7	6	15,0
200		25	7	10	20,0
250		25	8	10	25,0
300		25	8	10	30,0



Table 4

DN	D, outer diameter of the flange, mm	D1, centre distance of connection holes, mm	b, flange thickness, mm	L, construction length, mm	Number and diameter d of connection holes, mm
25	115	85	13	95	4-16
32	140	100	14	95	4-18
40	150	110	14	95	4-18
50	165	125	16	105	4-18
65	185	145	16	115	4-18
80	200	160	16	130	8-18
100	220	180	18	135	8-18
125	250	210	18	170	8-18
150	285	240	20	180	8-23
200	340	295	20	205	12-23
250	405	350	24	240	12-27
300	460	400	27	260	12-27

## 5. INSTALLATION AND OPERATING INSTRUCTIONS

- 5.1. The installation of pipe fittings must be carried out by persons who have studied this manual with its general requirements and the product-specific installation manual, who have completed labour protection training and who have practical experience in the installation of such equipment. The following persons are authorised to install the fittings.
- 5.2. The flange compensators can be installed in horizontal/vertical position on the pipeline.
- 5.3. Prior to installation, the supply and return pipes must be centred and fixed at a distance of no more than three pipe diameters from the compensator.
- 5.4. Deviation from the alignment of the compensator and the pipeline must not exceed 3 mm. Twisting of the insert is not permitted.
- 5.5. Install expansion joints taking into account the maximum permissible deformations given in Table 3.
- 5.6. The mating flanges must be thoroughly cleaned of dirt, sand, scale, etc. before the compensator is installed. Preferably collar flanges should be used.
- 5.7. It is not recommended to install additional gaskets between the compensator and the mating flanges during installation.
- 5.8. Tighten bolted joints evenly with a low torque.
- 5.9. The expansion joint must not be operated in tension and shear at the same time.
- 5.10. Tensile operation of the insert is not permitted when installed at the pump inlet.
- 5.11. The compensator must not be damaged by sharp edges of the pipe or the surface of the connection flange.



5.12. Bolts, nuts or studs must not come into contact with rubber (e.g. in the case of bolt-nut connections - nuts must be installed on the opposite side to the rubber elements - on the pipeline side).

5.13. Under normal conditions, the rubber compensator requires no special maintenance.

5.14. It is recommended to carry out periodic inspections of the compensator several times a year within the time limits set by the schedule according to the normative documents. During the inspection it is necessary to pay attention to the general condition of the compensator rubber and absence of damage on it.



## **6. TRANSPORT AND STORAGE CONDITIONS**

6.1. The compensators can be transported by any type of transport. The compensators must be mounted on transport vehicles to prevent mechanical damage and the internal surfaces must be protected from contamination.

6.2 When loading and unloading, the expansion joints should be slung by the housing.

6.3. Compensators should be stored in warehouses, protected from direct sunlight and removed at least 1 metre from heat-emitting devices, and should not be exposed to oil, petrol, substances aggressive to the materials of the product.

## **7. UTILISATION**

7.1. The product is disposed of in accordance with the procedure established at the enterprise (remelting, burial, resale).





## 8. WARRANTY OBLIGATIONS

8.1. Warranty period - 12 months from the date of commissioning, but not more than 18 months from the date of sale.

8.2. The warranty applies to equipment installed and used in accordance with the installation instructions and product specifications described in this data sheet.

8.3. The manufacturer guarantees compliance of the product with safety requirements, provided that the consumer complies with the rules of transport, storage, installation and operation.

8.4. The warranty covers all defects caused by the fault of the manufacturer.

8.5. The warranty does not apply:

- parts and materials of the product subject to wear and tear;
- for cases of damage caused by:
  - modifications to the original design of the product;
  - violation of general installation recommendations;
  - faults caused by improper maintenance and storage; improper operation and use of the equipment.

## 9. WARRANTY TERMS

9.1. Claims to the quality of the goods may be made during the warranty period.

9.2. Defective products are repaired or exchanged for new ones free of charge during the warranty period. ELEPHANT decides whether to replace or repair the product. The replaced product or its parts resulting from the repair shall become the property of 'ELEPHANT'.

9.3. Costs related to dismantling, installation and transport of the defective product during the warranty period shall not be reimbursed to the Buyer.

9.4. If the claim is unfounded, the Buyer shall pay the costs of diagnostics and expertise of the product.

9.5. Products are accepted for warranty repair (as well as for return) fully assembled.



## WARRANTY CARD № \_\_\_\_\_

№	Product Name	Packs

Name and address of the trading organisation \_\_\_\_\_

Date of sale \_\_\_\_\_ Seller's signature \_\_\_\_\_

Stamp or seal of the trading organisation \_\_\_\_\_ Acceptance stamp \_\_\_\_\_

I agree with the terms and conditions of the warranty:

Buyer \_\_\_\_\_ (signature)

Warranty period - 12 months from the date of commissioning, but not more than 18 months from the date of sale.

For warranty repairs, complaints and product quality claims, please contact ELEPHANT at: Carrer d'Aragó,264,3-1,08007 Barcelona, Spain\_E-mail address: sales@valveelephant.com.

When making a complaint about the quality of goods, the buyer shall present the following documents:

1. A free-form application, which shall specify:
  - name of the organisation or full name of the buyer, actual address, contact telephone numbers;
  - name and address of the organisation that carried out the installation;
  - basic parameters of the system in which the product was used;
  - a brief description of the defect.
2. Document confirming the purchase of the product (delivery note, receipt)..
3. Act of hydraulic test of the system in which the product was installed.
4. This completed warranty card.

A note on the return or exchange of goods \_\_\_\_\_

Date: « \_\_\_ » \_\_\_\_\_ 202\_\_ r. Caption \_\_\_\_\_

