



Manufacturer of shut-off and control valves

TECHNICAL DATA SHEET

**Bellows compensator ELEPHANT CB-3234-F
DN25-300 16 bar stainless steel, flanged**



+34 900 433 073, sales@valveelephant.com
Carrer d'Aragó, 264, 3-1, 08007 Barcelona, Spain

1. GENERAL PRODUCT INFORMATION

1.1. Product name: Bellows compensator ELEPHANT CB-3234-F DN25-300 16 bar stainless steel, flanged.

1.2. Purpose: The compensator is designed to reduce vibration and noise in pipelines due to pumps or other equipment. It also compensates for temperature displacements of pipelines and facilitates installation in case of slight misalignment of connecting system elements.

1.3. Principle of operation: The bellows, which is a corrugated elastic asymmetrical shell made of a metal alloy, compensates for shear due to its flexibility. Under the action of transverse, longitudinal forces, bending moments and angles of rotation, the component structure has the ability to stretch and compress, bend and change its shape transversely.



1.4. Deciphering of the designation:

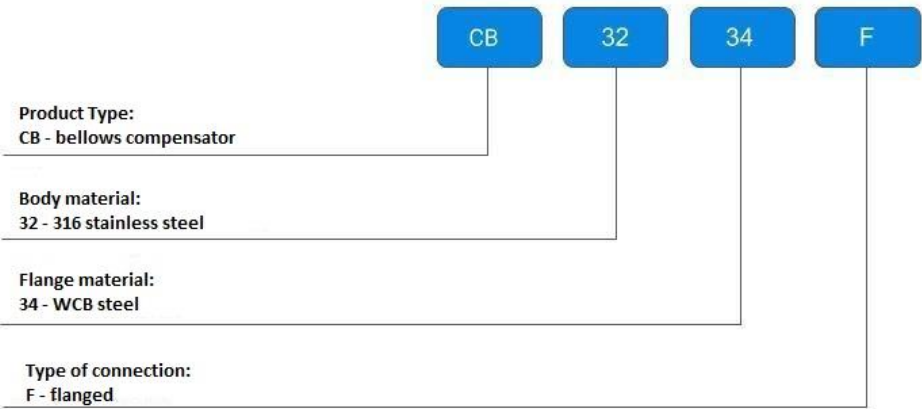

2. BASIC TECHNICAL DATA AND CHARACTERISTICS

Table 1

Nominal diameter DN, mm	25 - 300
Working pressure, bar	16
Operating medium temperature t, °C	≤550
Ambient temperature t, °C	-40 to 250
Operating medium	steam, oils, hot water, chemically aggressive media, within the performance limits
Bellows material	steel SS316
Connection to pipework	flanged
Flange material	steel WCB
Axial stroke, mm	30
Areas of application	heating and water supply systems; compressed air pipework; steam installations; industrial pipework.



3. WEIGHT AND DIMENSIONAL PARAMETERS

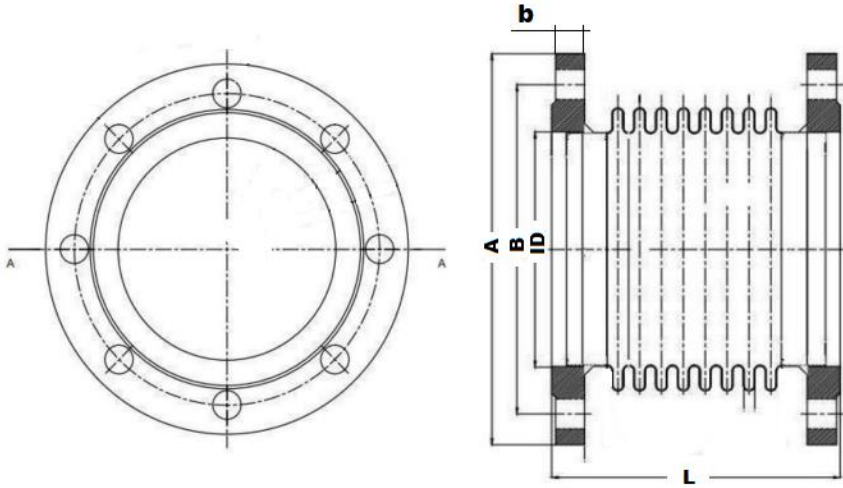

Table 2

DN	Permissible tensile strength, mm	Permissible compression, mm	ID, inner diameter of the flange, mm	A, outer flange diameter, mm	b, flange thickness, mm
25	15	15	38	115	16
32			42	140	16
40			48	150	16
50			60	165	18
65			76	185	18
80			89	200	20
100			114	220	20
125			139	250	22
150			168	285	22
200			219	340	24
250			270	405	26
300			323	460	28



Table 3

DN	B, centre distance of the flange holes, mm	Number and diameter of flange holes, mm	L, mm	Weight, kg
25	85	4-16	110	2,7
32	100	4-18	115	3,7
40	110	4-18	120	3,8
50	125	4-18	110	5,0
65	145	4-18	110	6,0
80	160	8-18	110	7,0
100	180	8-18	120	8,2
125	210	8-18	130	10,5
150	240	8-23	145	12,5
200	295	12-23	140	18,5
250	355	12-27	150	25,5
300	410	12-27	160	40,0



4. INSTALLATION AND OPERATING INSTRUCTIONS

- 4.1. The installation of pipe fittings must be carried out by persons who have studied this manual with its general requirements and the installation manual for the specific product, who have been trained in labour protection and who have practical experience in the installation of such equipment. The following persons are authorised to install the fittings.
- 4.2. Before installation, the compensator must be checked for compliance with the specifications and for defects or damage during transport.
- 4.3. Prior to installation, the supply and return pipes must be centred and fixed at a distance of no more than three pipe diameters from the compensator.
- 4.4. The axis of the pipeline section where the bellows compensator is installed and the compensator axis must coincide.
- 4.5. Only one compensator may be installed in a pipeline section between two fixed supports. The distance from the compensator to the fixed support must not be greater than a length equal to four nominal pipeline diameters.
- 4.6. **WARNING:** It is strictly forbidden that the expansion joint is tilted and sagging due to the weight of the pipeline or shut-off valves.
- 4.7. Before installing the compensator, the mating flanges must be thoroughly cleaned of dirt, sand, scale, etc..
- 4.8. Tighten bolted joints evenly with a low torque.
- 4.9. The expansion joint must not be operated in tension and shear at the same time.
- 4.10. Under normal conditions, the bellows compensator requires no special maintenance.
- 4.11. It is recommended to carry out periodic inspections of the compensator several times a year within the time limits set by the schedule according to the normative documents. During the inspection, attention should be paid to the general condition of the compensator bellows and the absence of damage on it.



5. TRANSPORT AND STORAGE CONDITIONS

5.1. The compensators can be transported by any type of transport. The compensators must be mounted on transport vehicles to prevent mechanical damage and the internal surfaces must be protected from contamination.

5.2. Compensators should be stored in warehouses, protected from direct sunlight and removed at least 1 metre from heat-emitting devices, and should not be exposed to oil, petrol, substances aggressive to the materials of the product.

6. UTILISATION

6.1. The product is disposed of in accordance with the procedure established at the enterprise (remelting, burial, resale).



7. WARRANTY OBLIGATIONS

7.1. Warranty period - 12 months from the date of commissioning, but not more than 18 months from the date of sale.

7.2. The warranty applies to equipment installed and used in accordance with the installation instructions and product specifications described in this data sheet.

7.3. The manufacturer guarantees compliance of the product with safety requirements, provided that the consumer complies with the rules of transport, storage, installation and operation.

7.4. The warranty covers all defects caused by the fault of the manufacturer.

7.5. The warranty does not apply:

- parts and materials of the product subject to wear and tear;
- for cases of damage caused by:
 - modifications to the original design of the product;
 - violation of general installation recommendations;
 - faults caused by improper maintenance and storage; improper operation and use of the equipment.

8. WARRANTY TERMS

8.1. Claims to the quality of the goods may be made during the warranty period.

8.2. Defective products are repaired or exchanged for new ones free of charge during the warranty period. ELEPHANT decides whether to replace or repair the product. The replaced product or its parts resulting from the repair shall become the property of 'ELEPHANT'.

8.3. Costs related to dismantling, installation and transport of the defective product during the warranty period shall not be reimbursed to the Buyer.

8.4. If the claim is unfounded, the Buyer shall pay the costs of diagnostics and expertise of the product.

8.5. Products are accepted for warranty repair (as well as for return) fully assembled.



WARRANTY CARD № _____

№	Product Name	Packs

Name and address of the trading organisation _____

Date of sale _____ Seller's signature _____

Stamp or seal of the trading organisation _____ Acceptance stamp _____

I agree with the terms and conditions of the warranty:

Buyer _____ (signature)

Warranty period - 12 months from the date of commissioning, but not more than 18 months from the date of sale.

For warranty repairs, complaints and product quality claims, please contact ELEPHANT at: Carrer d'Aragó,264,3-1,08007 Barcelona, Spain_E-mail address: sales@valveelephant.com.

When making a complaint about the quality of goods, the buyer shall present the following documents:

1. A free-form application, which shall specify:
 - name of the organisation or full name of the buyer, actual address, contact telephone numbers;
 - name and address of the organisation that carried out the installation;
 - basic parameters of the system in which the product was used;
 - a brief description of the defect.
2. Document confirming the purchase of the product (delivery note, receipt)..
3. Act of hydraulic test of the system in which the product was installed.
4. This completed warranty card.

A note on the return or exchange of goods _____

Date: « ___ » _____ 202__ r. Caption _____

